

IMPRIERE

BIG 3D INTER+ 

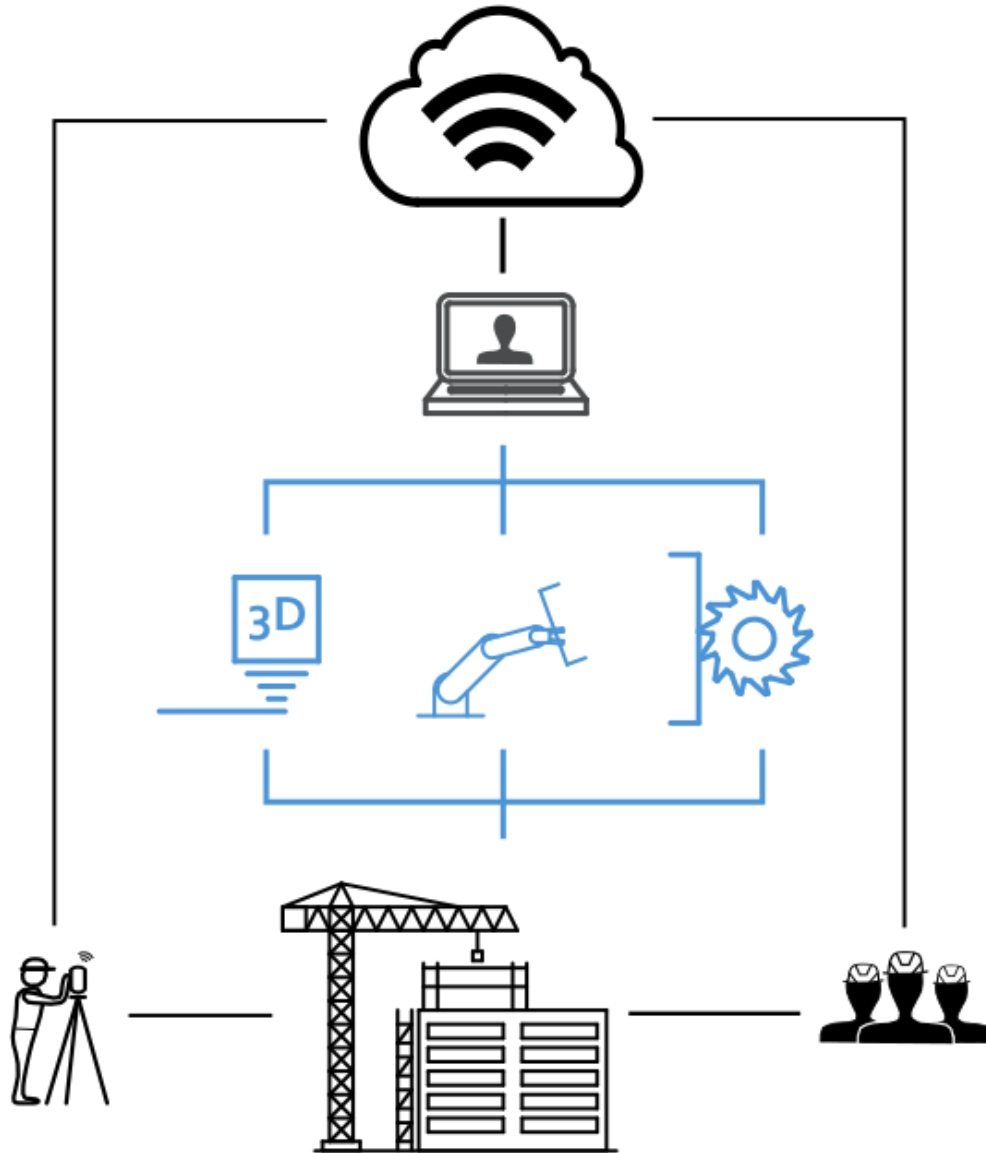

WE DIGITIZE THE
BUILDING INDUSTRY

BIG 3D-Printer 1063

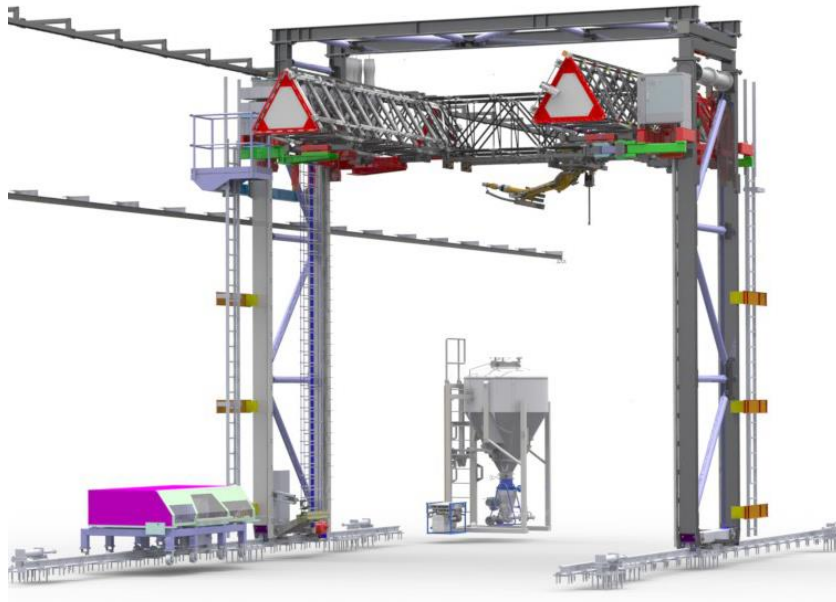

Max. printing dimensions (L x B x H):	5.75 m x 2.96 m x 6.25 m
Print volume:	106.3 m ³
Layer width:	4.0 cm - 6.0 cm
Layer height:	0.5 cm – 3.0 cm
Print speed:	100 mm/s – 500 mm/s
Material consumption:	0.9 l/min. – 54.0 l/min.
Number of axes:	10 (4 + 6)
Transport+ cutting of the reinforcing bars:	automatically
Inserting the reinforcing bars:	automatically
Postprocessing surface:	milling spindle
Operators:	2
Space requirements: (L x B x H):	20 m x 7.0 m x 9.5 m (without u-axis)
Requirements Location:	level, solid foundation foundation plus a wall or supporting structure on one side

IMPRIMERE AG

Industriezone Schächenwald

CH- 6460 Altdorf

T +41 41 610 44 65

F + 41 41 610 27 09

www.imprimere.ch

mail@imprimere.ch

Subject to alterations and adaptations. V9-17